

# ENGLANDS



40 Hartledon Road

Harborne, Birmingham, B17 0AD

£300,000





## PROPERTY DESCRIPTION

Traditional terraced property set in a very popular location and briefly comprising: two reception rooms, kitchen, outhouse with laundry facilities, two bedrooms, bathroom, newly-fitted gas combi boiler and attractive South-facing rear garden. NO CHAIN.

Hartledon Road is well-situated between War Lane and Victoria Road. It is readily accessible to the Queen Elizabeth Medical Complex, The University of Birmingham and Harborne Leisure Centre, as well as excellent amenities around Harborne High Street, good local primary schools, two golf courses and regular transport services leading through to comprehensive City Centre leisure, entertainment and shopping facilities.

The property is set in an elevated position from the road, with steps and pathway leading to front door.





## FRONT RECEPTION ROOM

3.92 max into bay x 3.65 max into recess (12'10" max into bay x 11'11" max into recess )  
Having UPVC double glazed bay window overlooking the front, ceiling light point, radiator, laminate flooring, coving to ceiling, picture rail, ceiling light point with ceiling rose, and Dado rail.

## DINING ROOM

3.75 max x 3.64 max into recess (12'3" max x 11'11" max into recess )  
Having radiator, laminate flooring, coving to ceiling, ceiling light point with ceiling rose, UPVC double glazed window, decorative timber fireplace with marble style insert and hearth and fitted gas fire.

## KITCHEN

4.16 max x 1.93 max (13'7" max x 6'3" max )  
Having two UPVC double glazed windows, a range of base units, roll top work surfaces, full complementary tiling to walls, integrated electric oven and hob with wall mounted extractor fan over, tiled flooring, radiator, ceiling light point. 1 1/2 bowl stainless steel sink drainer with mixer tap over and appliance space with plumbing for dishwasher.

## LAUNDRY OUTHOUSE

2.55 max x 1.75 max (8'4" max x 5'8" max )  
Having UPVC double glazed window to the side and UPVC double glazed French door opening out to the garden, tiled floor, wall and base units, part complementary tiling to walls, tiled floor and ceiling light point.

## STAIRS RISING TO FIRST FLOOR ACCOMMODATION

## LANDING

Having radiator, two ceiling light points and loft access hatch.

## BEDROOM ONE - FRONT

3.67 max into recess x 3.47 max (12'0" max into recess x 11'4" max )  
Having two UPVC double glazed windows, radiator, laminate flooring, coving to ceiling, ceiling light point and useful built in storage cupboard.

## BEDROOM TWO

3.77 max x 2.71 max into recess (12'4" max x 8'10" max into recess )  
Having UPVC double glazed window overlooking the rear, radiator, ceiling light point and laminate flooring.

## BATHROOM

Having panelled bath with mixer tap over and wall-mounted shower attachment, pedestal wash hand basin with mixer tap over, low flush WC, UPVC double glazed window with obscured glazing, part complementary to walls, radiator, ceiling light point and cupboard housing the recently fitted MAIN gas Combi boiler.

## OUTSIDE

Attractive low maintenance rear garden comprising Quarry tiled seating areas (original tiles re-purposed from inside the property), steps up to gravel area having fence panels to three sides, with conifers also along the borders, some evergreen shrubs and gate leading to the rear access.

## ADDITIONAL INFORMATION

TENURE: FREEHOLD  
COUNCIL TAX BAND - C



# ENGLANDS



## ROAD MAP

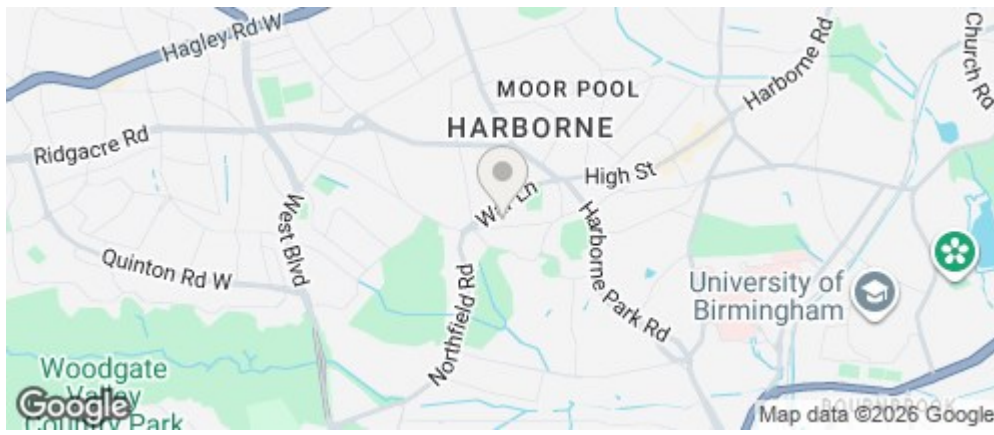

## ENERGY EFFICIENCY GRAPH

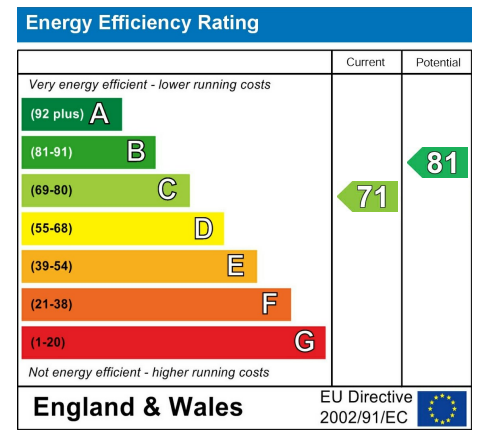

## FLOOR PLAN

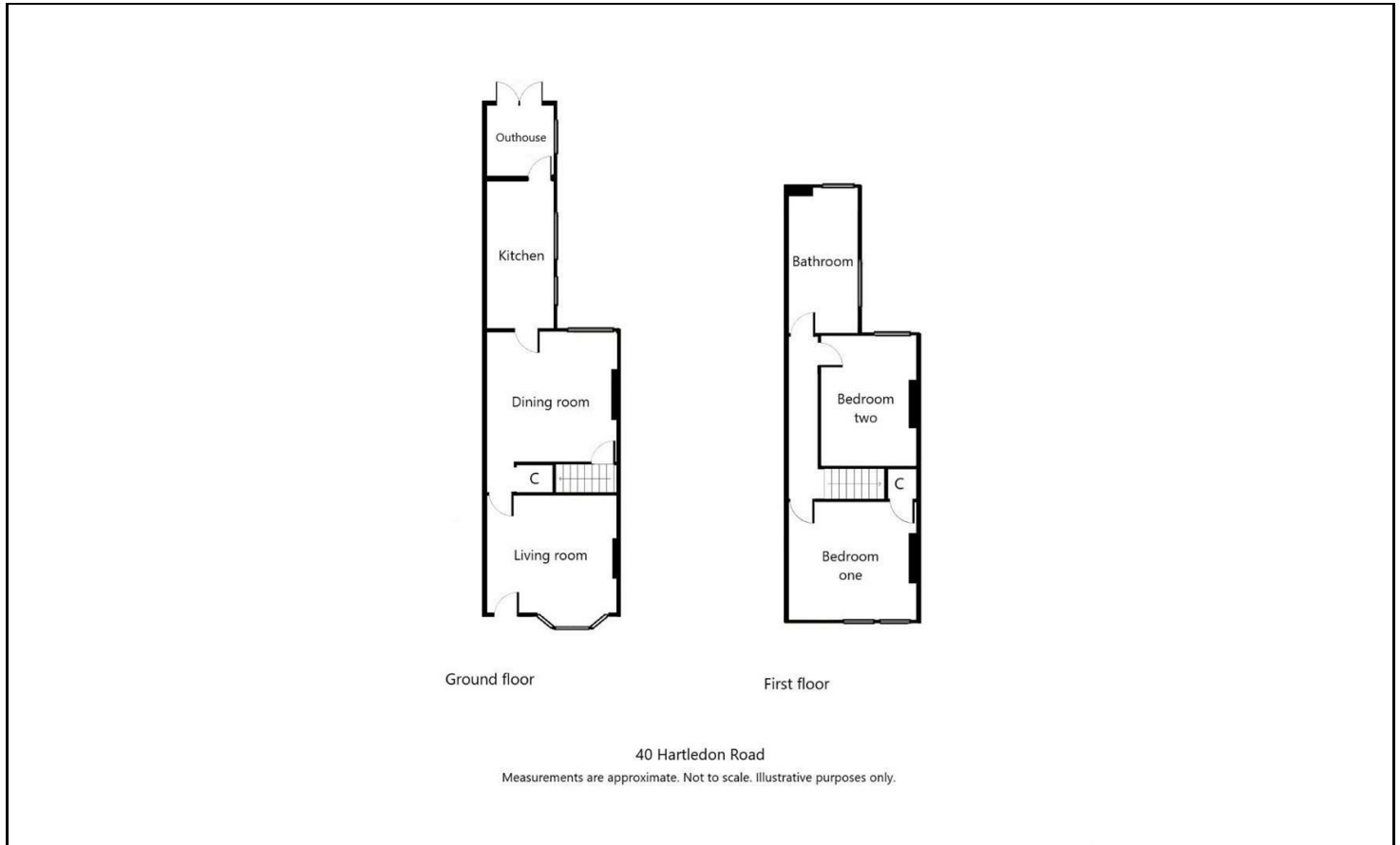

### DISCLAIMER NOTICES

“The agent has not tested any apparatus, equipment, fixture, fittings or services, and so does not verify they are in working order, fit for their purpose, or within ownership of the sellers, therefore the buyer must assume the information given is incorrect. Neither has the agent checked the legal documentation to verify legal status of the property or the validity of any guarantee. A buyer must assume the information is incorrect, until it has been verified by their own solicitors. The measurements supplied are for general guidance, and as such, must be considered as incorrect. A buyer is advised to re-check the measurements themselves before committing themselves to any expense. Nothing concerning the type of construction, or condition of the structure is to be implied from the photograph of the property. The sales particulars may change in the course of time, and any interested party is advised to make final inspection of the property prior to exchange of contracts.”

### Misrepresentation Act 1967

“These details are prepared as a general guide only and should not be relied upon as a basis to enter into a legal contract, or to commit expenditure. An interested party should consult their own surveyor, solicitor or other professional before committing themselves to any expenditure or other legal commitments. If any interested party wishes to rely upon any information from the agent, then a request should be made, and specific written confirmation can be provided. The agents will not be responsible for any verbal statement made by any member of staff, as only a specific written confirmation should be relied upon. The agent will not be responsible for any loss other than when specific written confirmation has been requested.”

These particulars, whilst believed to be accurate are set out as a general outline only for guidance and do not constitute any part of an offer or contract. Intending purchasers should not rely on them as statements of representation of fact, but must satisfy themselves by inspection or otherwise as to their accuracy. No person in this firm's employment has the authority to make or give any representation or warranty in respect of the property.